

YOUR BUTTERFLY

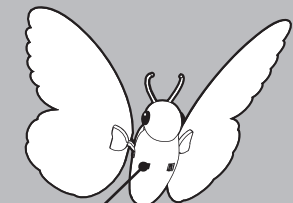

Butterfly
Contacts

YOUR FLOWER CHARGER

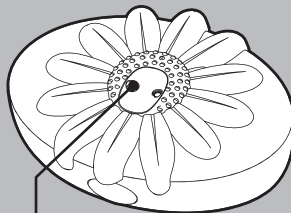

Charger
Contacts

ON-OFF Switch

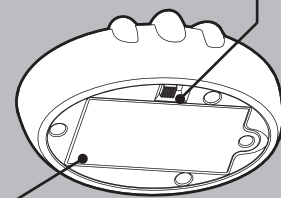

Battery Compartment

BATTERIES

**Requires 2 x AA/LR06 Batteries.
(Batteries Not Included)**

- Use new batteries to obtain best performance.
- Alkaline batteries recommended.
- Do not use rechargeable batteries.
- Non-rechargeable batteries are not to be recharged.
- Different types of batteries or new and used batteries are not to be mixed.
- Only batteries of the same or equivalent type as recommended are to be used.
- Batteries should be replaced by an adult.
- Batteries are to be inserted with the correct polarity.
- Exhausted batteries are to be removed from product.
- The supply terminals are not to be short-circuited.
- Batteries are to be removed from the product when not in use.
- Do not dispose of batteries in fire.

IMPORTANT NOTE ON BATTERY REPLACEMENT

If Butterfly's movement does not function properly
DO NOT RETURN TO THE STORE.
Replace with fresh batteries as shown.

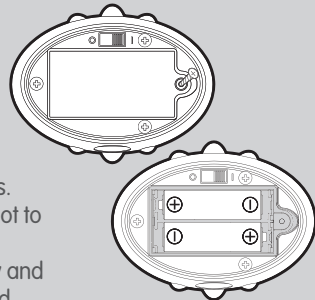

KEEPING YOUR BUTTERFLY HAPPY

Your Butterfly loves attention and its behaviour will change depending on how much you play with it and feed it.

You will know how happy your Butterfly is by the way it flutters its wings and the length of time it flutters them in your hand.



A LONELY BUTTERFLY: Flutters very fast with a jittery movement for around 30 seconds.



A CONTENT BUTTERFLY: Flutters quickly in a random pattern for around 40 seconds.



A HAPPY BUTTERFLY: Flutters with a smooth medium-paced movement for around 50 seconds.



A JOYFUL BUTTERFLY: Flutters with a slow smooth pace for around 60 seconds.

CARING FOR YOUR BUTTERFLY

To hold your Butterfly, gently pick it up with two fingers pinching the back of its body. Do not pick your Butterfly up by its wings.

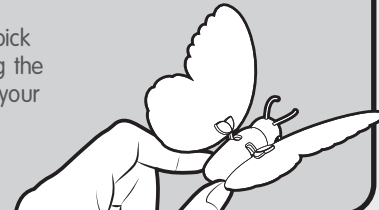

FEEDING

Ensure your Flower Charger is switched on.



If you want to play with your Butterfly you must feed it first. Do this by placing the Butterfly on the Flower Charger. Ensure it sits correctly on the flower as shown with its tail above the logo sticker.

While feeding your Butterfly it will flutter its wings. When it stops fluttering you know it's ready to play.

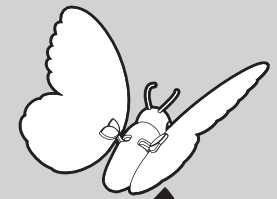

Logo
Sticker

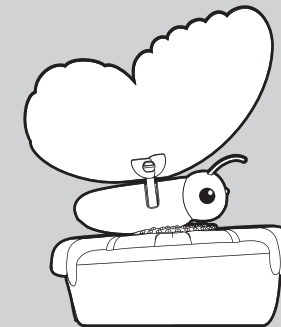

PLAY

To play with your Butterfly, take it off the Flower Charger and place it in the palm of your hand. Watch as your Butterfly flutters its wings to show you how happy it is.

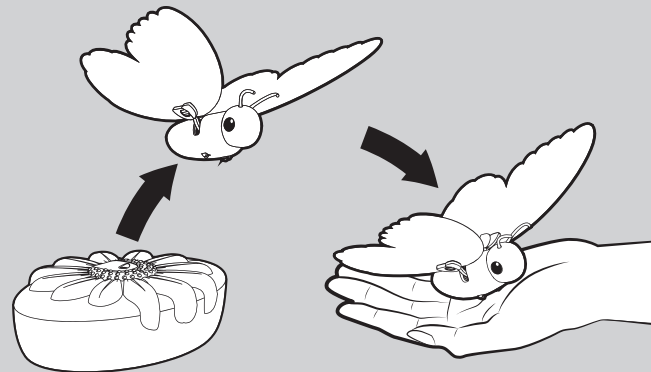

Remember that the more you play with and feed your Butterfly the happier it will be. If you don't play frequently with your Butterfly it will get lonely, so always pay it attention.

SLEEP

When you leave your Butterfly alone on the Flower Charger it will start to get sleepy.

Watch carefully as it will occasionally flutter its wings to get your attention! If you don't play with it it will get tired and fall asleep.

You can wake it up at any time by taking it off the Flower Charger.

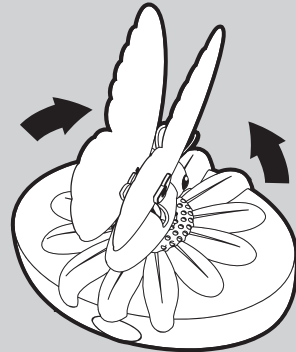

TROUBLESHOOTING

Butterfly does not move its wings



- Ensure your Charger is switched on.
- Ensure Charger has fresh batteries, and that they are placed in correct polarity.
- When placing Butterfly on Charger, make sure the positioning is correct and the contacts on the underside of the Butterfly are lined up with those on the Charger (as shown under FEEDING section).
- When on the Charger, give the Butterfly a slight jiggle to ensure the contacts are fully touching.

Butterfly does not flutter for long when taken off the Charger

- Ensure you allow your Butterfly to feed for more than 10 seconds – this charges the Butterfly's power source.
- Your batteries may be running flat. Replace your Charger with fresh batteries.

Butterfly flutters for only 10 seconds when placed on the Charger

- This is a secret little dance that the Butterfly does. It happens when you take the Butterfly off and place it back on the Charger quickly. To get the normal wing behavior and to see what mood it's in, allow at least 5 seconds before putting the Butterfly back on the Charger.

FCC STATEMENT

This device complies with part 15 of the FCC rules. Operation is subject to the following two conditions: (1) This device may not cause harmful interference, and (2) this device must accept any interference received, including interference that may cause undesired operation.

CAUTION: Changes or modifications not expressly approved by the party responsible for compliance could void the user's authority to operate the equipment.

NOTE: This equipment has been tested and found to comply with the limits for a Class B digital device, pursuant to Part 15 of the FCC Rules. These limits are designed to provide reasonable protection against harmful interference in a residential installation. This equipment generates, uses and can radiate radio frequency energy and, if not installed and used in accordance with the instructions, may cause harmful interference to radio communications. However, there is no guarantee that interference will not occur in a particular installation. If this equipment does cause harmful interference to radio or television reception, which can be determined by turning the equipment off and on, the user is encouraged to try to correct the interference by one or more of the following measures:

- Reorient or relocate the receiving antenna.
- Increase the separation between the equipment and receiver.
- Connect the equipment into an outlet on a circuit different from that to which the receiver is connected.
- Consult the dealer or experienced radio/TV technician for help.

DISCLAIMER

WARNING: NOT SUITABLE FOR CHILDREN UNDER 3 YEARS.

CAUTION: ADULT SUPERVISION SHOULD BE ENCOURAGED FOR YOUNG CHILDREN.

IMPORTANT: DROPPING LITTLE LIVE PETS™ TOY MAY CAUSE DAMAGE THAT PREVENTS LITTLE LIVE PETS™ FUNCTIONS. PLEASE RETAIN PACKAGING DETAILS FOR FUTURE REFERENCE SINCE THEY CONTAIN IMPORTANT INFORMATION. READ ALL INSTRUCTIONS CAREFULLY BEFORE USING PRODUCT. COLORS AND CONTENTS MAY VARY.

INCLUDES:

1 Butterfly, 1 Charger, 1 Instruction booklet.



WWW.LITTLELIVEPETS.COM



www.moosetoy.com

©2019 Moose.
MADE IN CHINA



INSTRUCTION BOOKLET

