

Creative
Maker
Kitz

6x CARD SHEETS
3x PAPER SHEETS
6x L.E.D LIGHTS



**NEED HELP
TO BUILD?**

Scan Code For
Video Instruction
www.bladetoys.com/hpmk



FOR STRONGER
BUILD ADD PVA
GLUE TO JOINTS

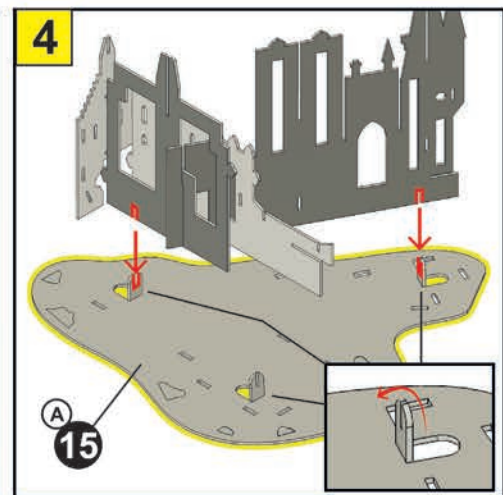
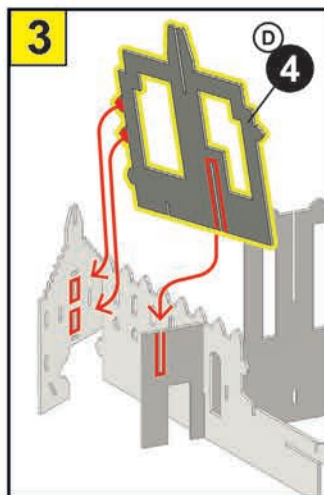
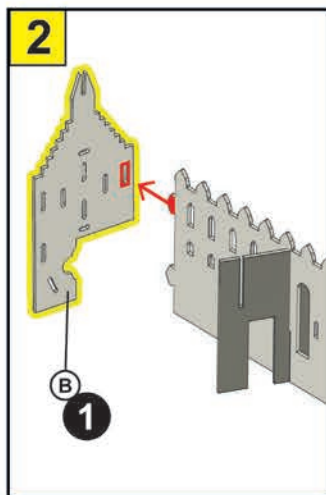
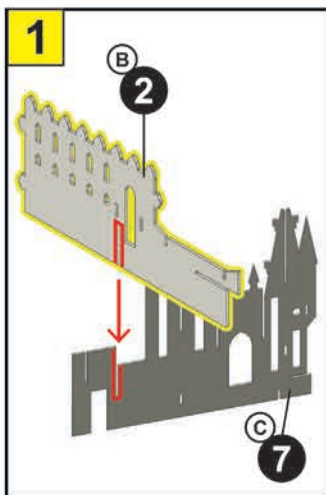
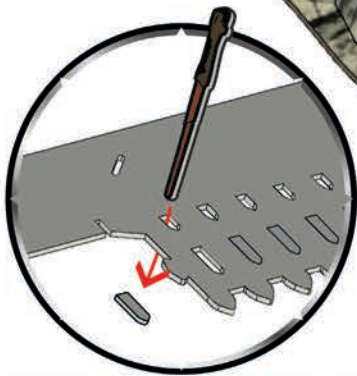

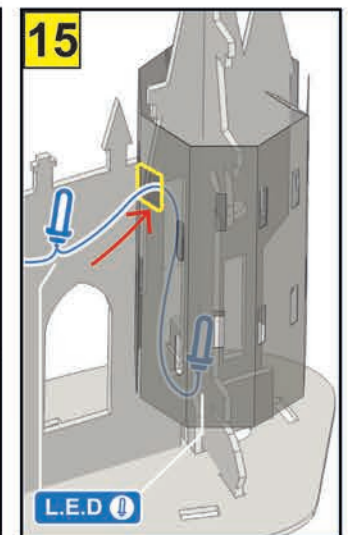
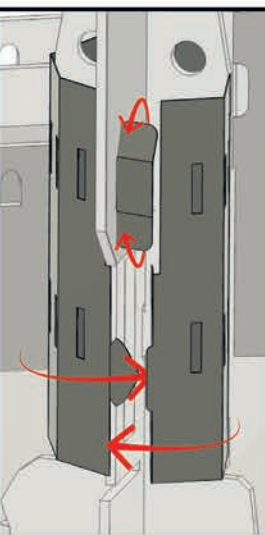
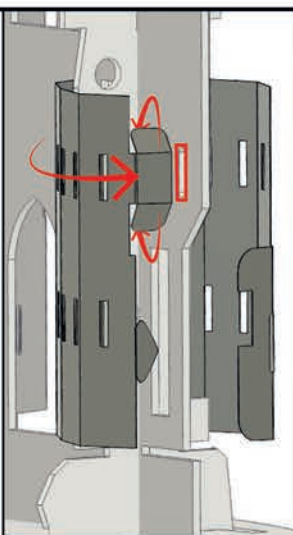
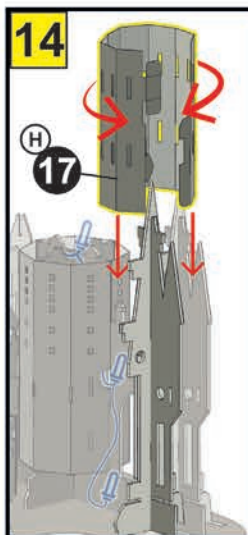
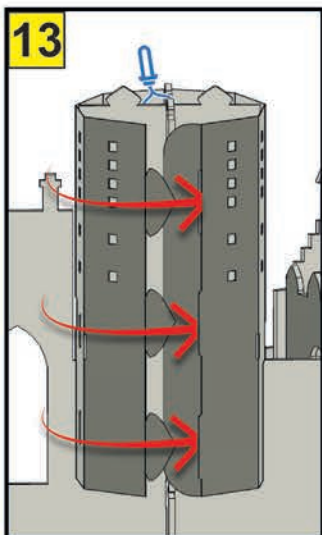
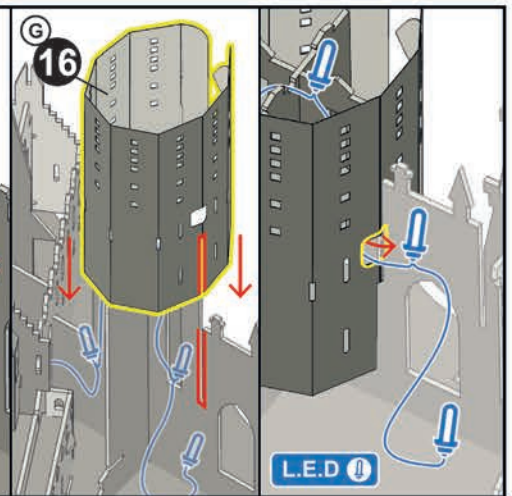
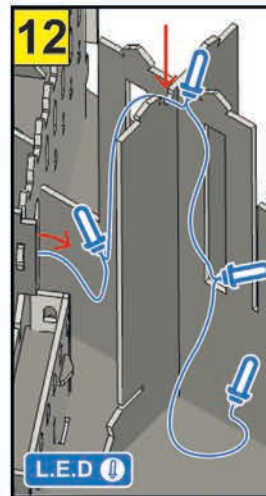
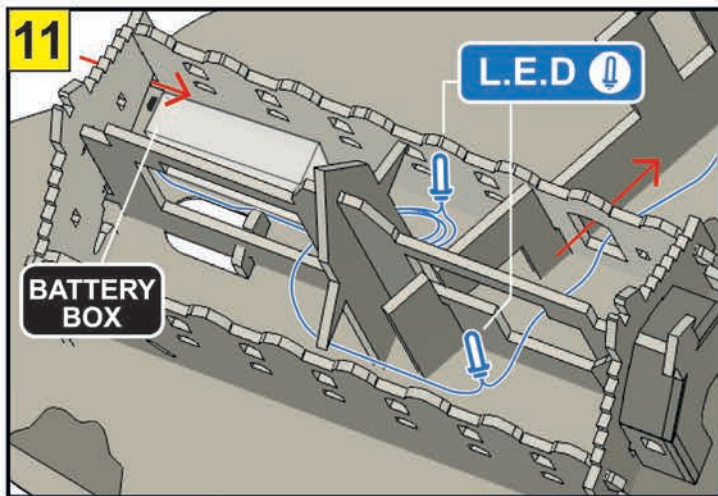
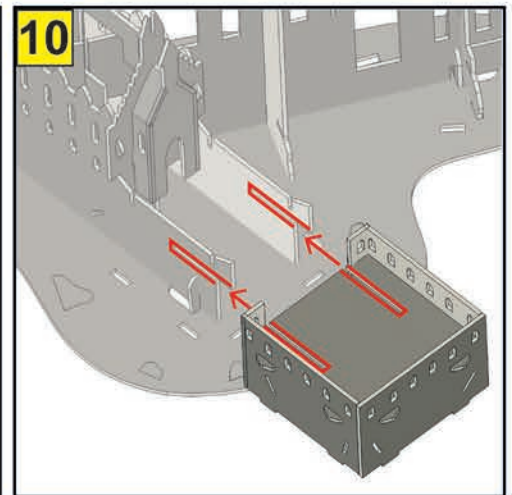
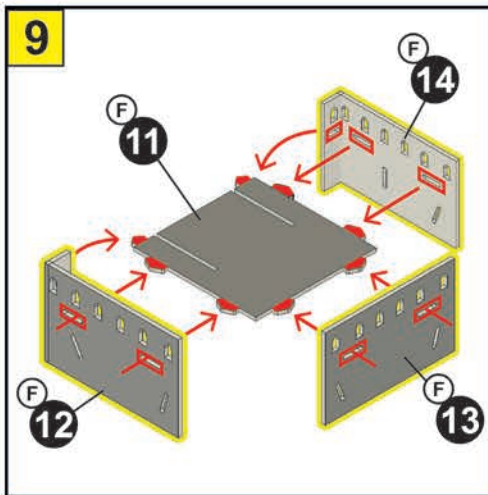
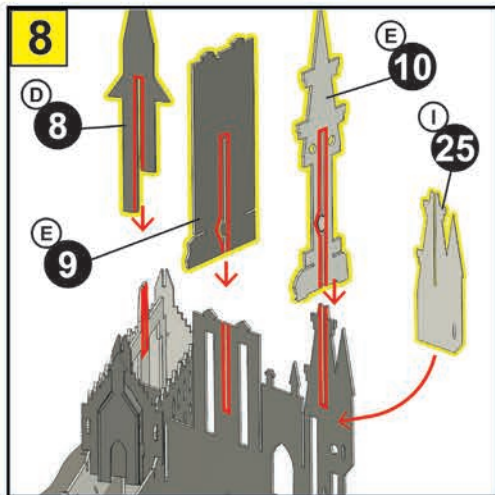
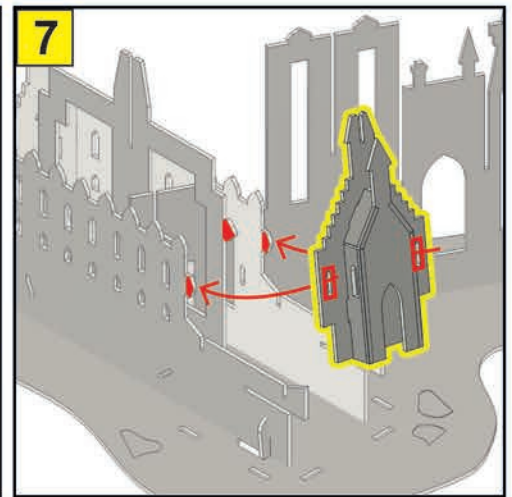
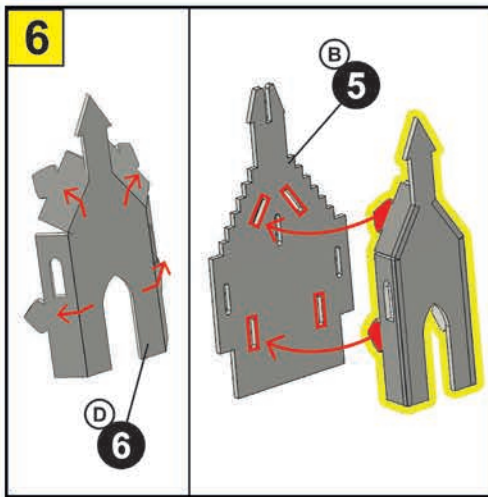
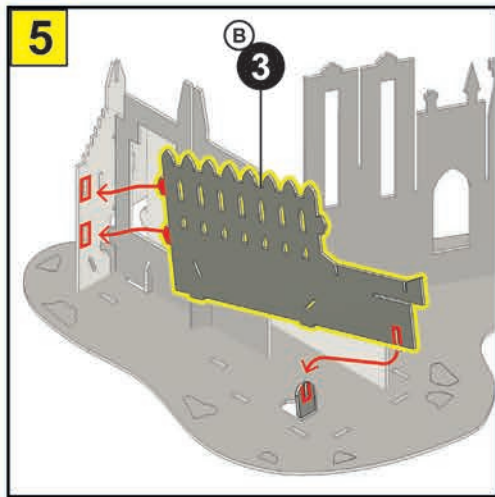

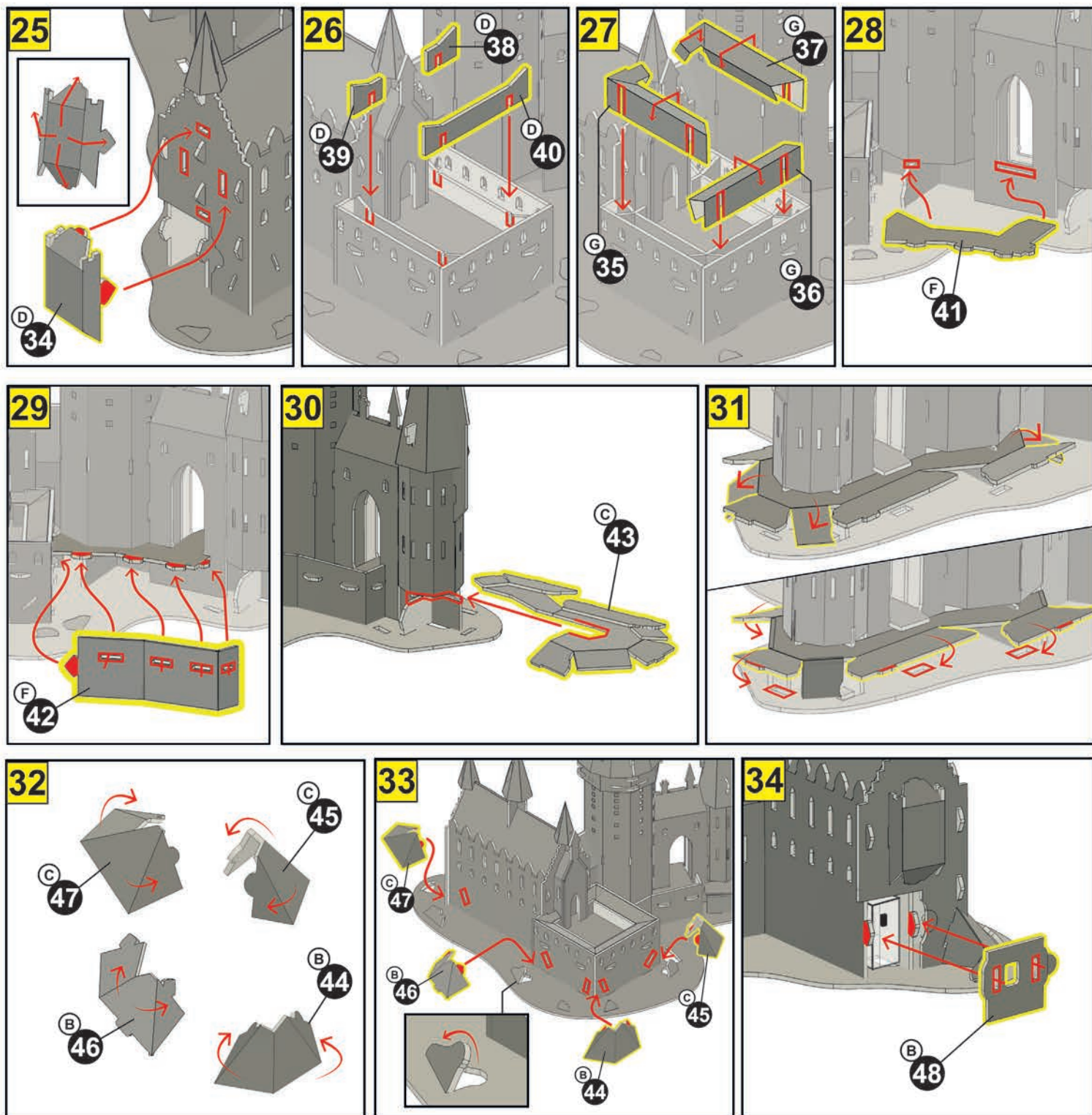

BATTERY AND SET UP INFORMATION

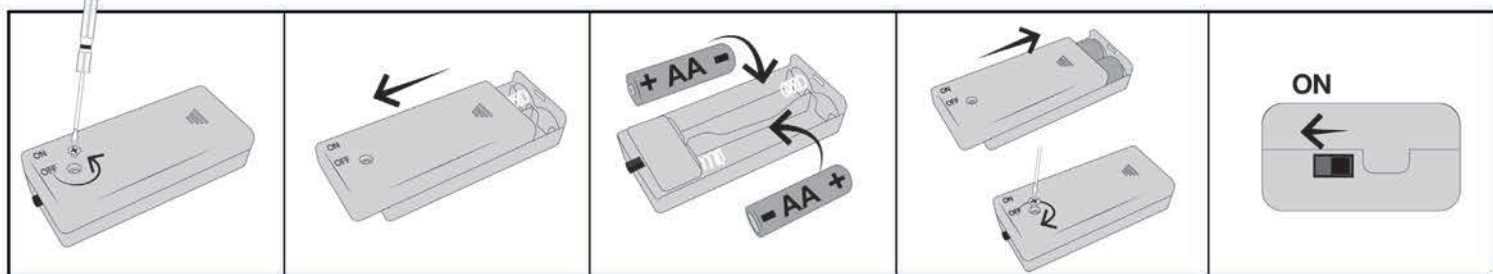

GB WARNING! Not suitable for children under the age of 3 years due to small parts which may present a Choking Hazard and length of cord which may present a Strangulation Hazard. Adult supervision required at all times. Remove all packaging before giving this toy to a child. Read instructions before use. Please retain this information for future reference. Colour and contents may vary. Wipe clean with a dry cloth only, do not submerge in water.

Battery Safety information: Different types of batteries or new and used batteries are not to be mixed. Non rechargeable batteries are not to be recharged. Rechargeable batteries are to be removed from the toy before being recharged. Rechargeable batteries are only to be recharged under adult supervision. Exhausted batteries are to be removed from the toy. Supply terminals are not to be short circuited. Batteries to be replaced by an adult. Batteries are to be inserted with the correct polarity. Alkaline batteries recommended. Do not dispose of batteries in fire as the battery may explode or leak. The wheellie bin symbol indicates that you should not dispose of this product and batteries in house hold waste. Please recycle where facilities exist. Check with your local authority or retailer for recycling advice.



Manufactured by Bladez Toys Ltd, P02 8FA, UK.
 © 2021 Bladez Toys Ltd. All Rights Reserved.
 www.bladeztoys.com / support@bladeztoys.co.uk
 +44(0) 2392 658 255
 MADE IN CHINA



WIZARDING WORLD characters, names and related indicia are © & ™ Warner Bros. Entertainment Inc. WB SHIELD: © & ™ WBEL. Publishing Rights © JKR. (s21)

BTHP-C09